

# LINK ROOF

Modified on: Sat, 9 Jan, 2021 at 7:34 PM

## Link Roof

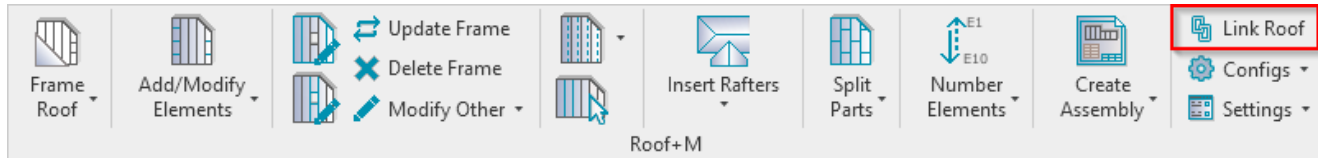

**Link Roof** – makes a link between roof type from the project and the configuration. Choose the roof type you want to link and apply framing configuration to the layers.

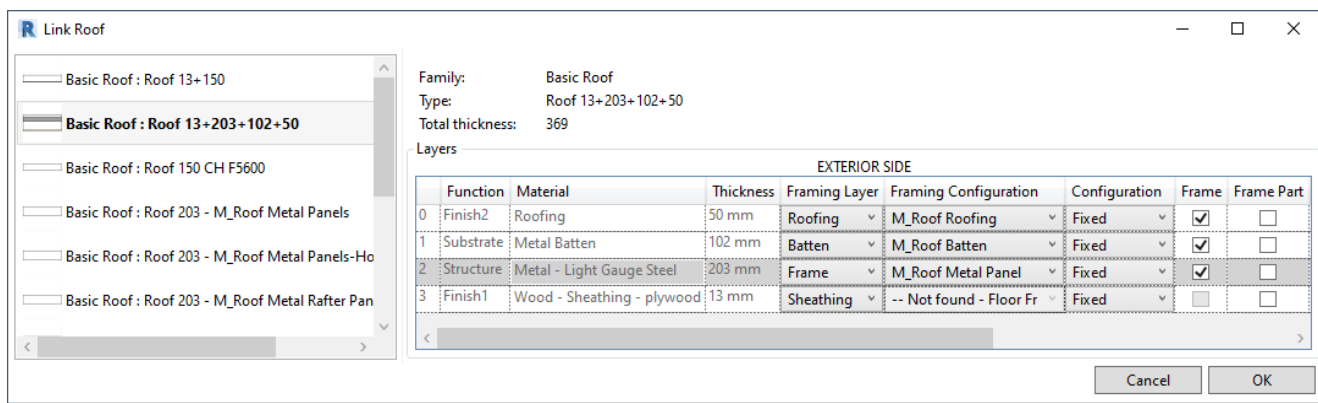

### Dialog:

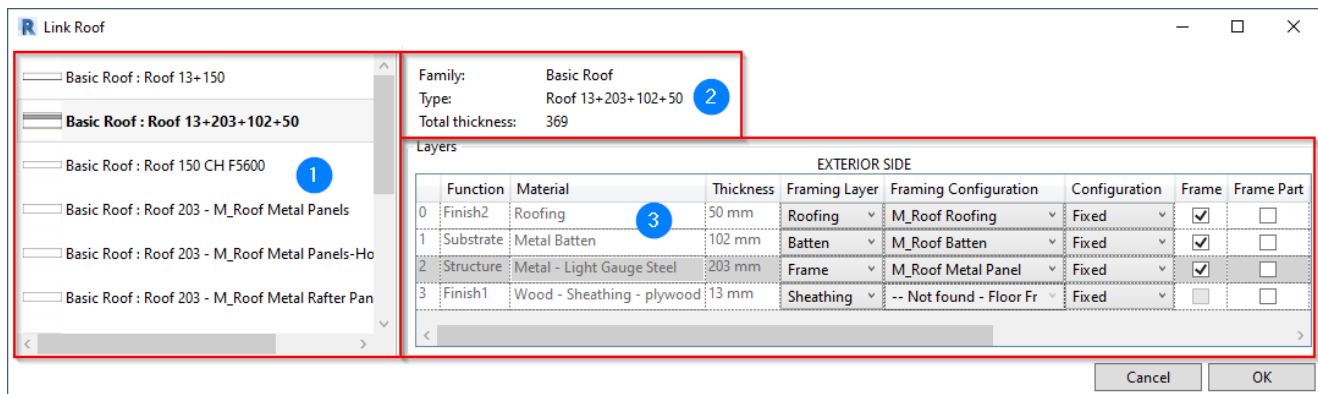

In the above dialog, you can see:

1. All roof types from the current project. If you select a roof from the project, it will automatically be selected in this dialog so that you can quickly apply settings.
2. Information of selected type.
3. Information of selected roof layers where you can apply settings.

Information from selected roof type:

*Note: Material is mandatory for assigning framing configuration!*

Family: Basic Roof  
 Type: Roof 13+203+102+50  
 Total thickness: 369

## Layers

EXTERIOR SIDE								
	Function	Material	Thickness	Framing Layer	Framing Configuration	Configuration	Frame	Frame Part
0	Finish2	Roofing	50 mm	Roofing	M_Roof Roofing	Fixed	<input checked="" type="checkbox"/>	<input type="checkbox"/>
1	Substrate	Metal Batten	102 mm	Batten	M_Roof Batten	Fixed	<input checked="" type="checkbox"/>	<input type="checkbox"/>
2	Structure	Metal - Light Gauge Steel	203 mm	Frame	M_Roof Metal Panel	Fixed	<input checked="" type="checkbox"/>	<input type="checkbox"/>
3	Finish1	Wood - Sheathing - plywood	13 mm	Sheathing	-- None --	Fixed	<input type="checkbox"/>	<input type="checkbox"/>

## Framing Layer

Family: Basic Roof  
 Type: Roof 13+203+102+50  
 Total thickness: 369

## Layers

EXTERIOR SIDE								
	Function	Material	Thickness	Framing Layer	Framing Configuration	Configuration	Frame	Frame Part
0	Finish2	Roofing	50 mm	Roofing	M_Roof Roofing	Fixed	<input checked="" type="checkbox"/>	<input type="checkbox"/>
1	Substrate	Metal Batten	102 mm	Batten	M_Roof Batten	Fixed	<input checked="" type="checkbox"/>	<input type="checkbox"/>
2	Structure	Metal - Light Gauge Steel	203 mm	Frame	M_Roof Metal Panel	Fixed	<input checked="" type="checkbox"/>	<input type="checkbox"/>
3	Finish1	Wood - Sheathing - plywood	13 mm	Sheathing	-- None --	Fixed	<input type="checkbox"/>	<input type="checkbox"/>

Select which framing layer has to be created.

Possible options: **Frame**, **Secondary Frame**, **Roofing**, **Battens**, **Paneling**, and two **Sheathing** layers.

## Framing Configuration

Family: Basic Roof  
 Type: Roof 13+203+102+50  
 Total thickness: 369

## Layers

EXTERIOR SIDE								
	Function	Material	Thickness	Framing Layer	Framing Configuration	Configuration	Frame	Frame Part
0	Finish2	Roofing	50 mm	Roofing	M_Roof Roofing	Fixed	<input checked="" type="checkbox"/>	<input type="checkbox"/>
1	Substrate	Metal Batten	102 mm	Batten	M_Roof Batten	Fixed	<input checked="" type="checkbox"/>	<input type="checkbox"/>
2	Structure	Metal - Light Gauge Steel	203 mm	Frame	M_Roof Metal Panel	Fixed	<input checked="" type="checkbox"/>	<input type="checkbox"/>
3	Finish1	Wood - Sheathing - plywood	13 mm	Sheathing	-- None --	Fixed	<input type="checkbox"/>	<input type="checkbox"/>

**Framing Configuration** – select framing configuration with the definition of all framing parameters. There are default configurations that come with **Roof+M**, but you can also create your own.

The list of framing configurations comes from the **Framing Configuration** dialog:

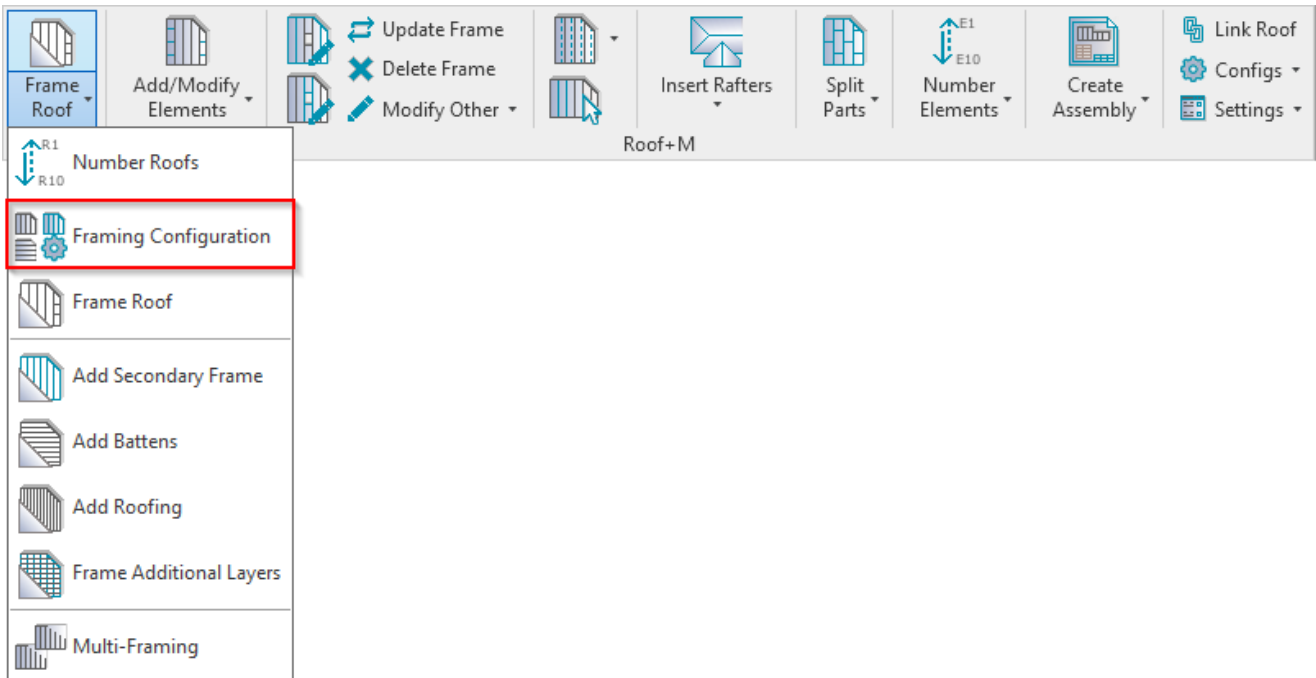

OR:

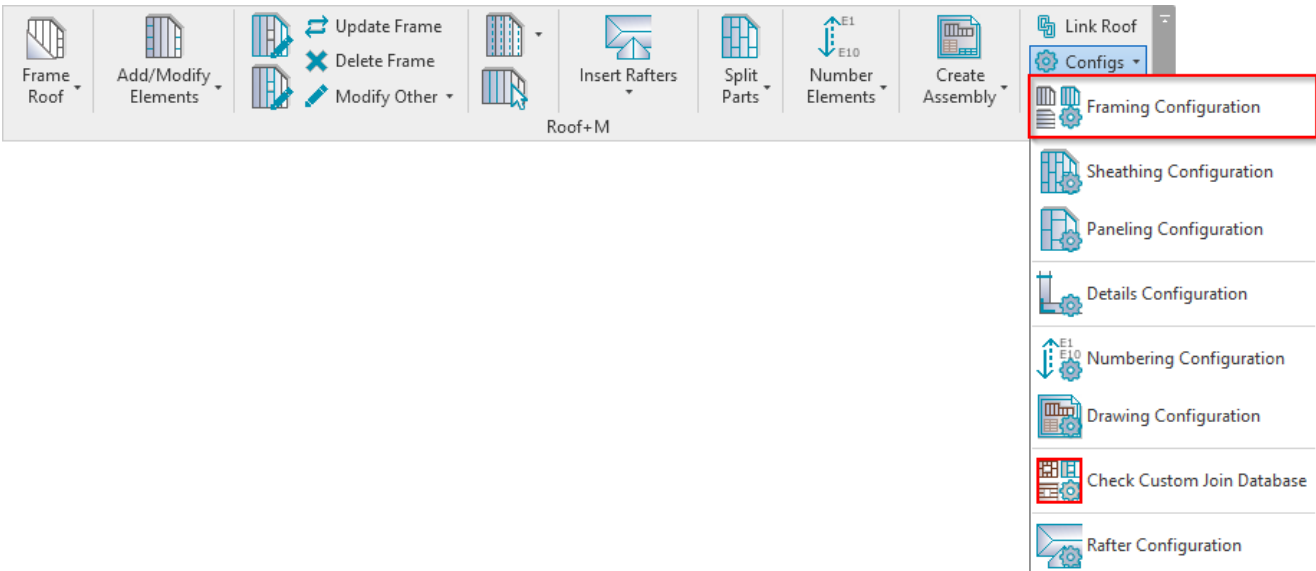

The list of configurations:

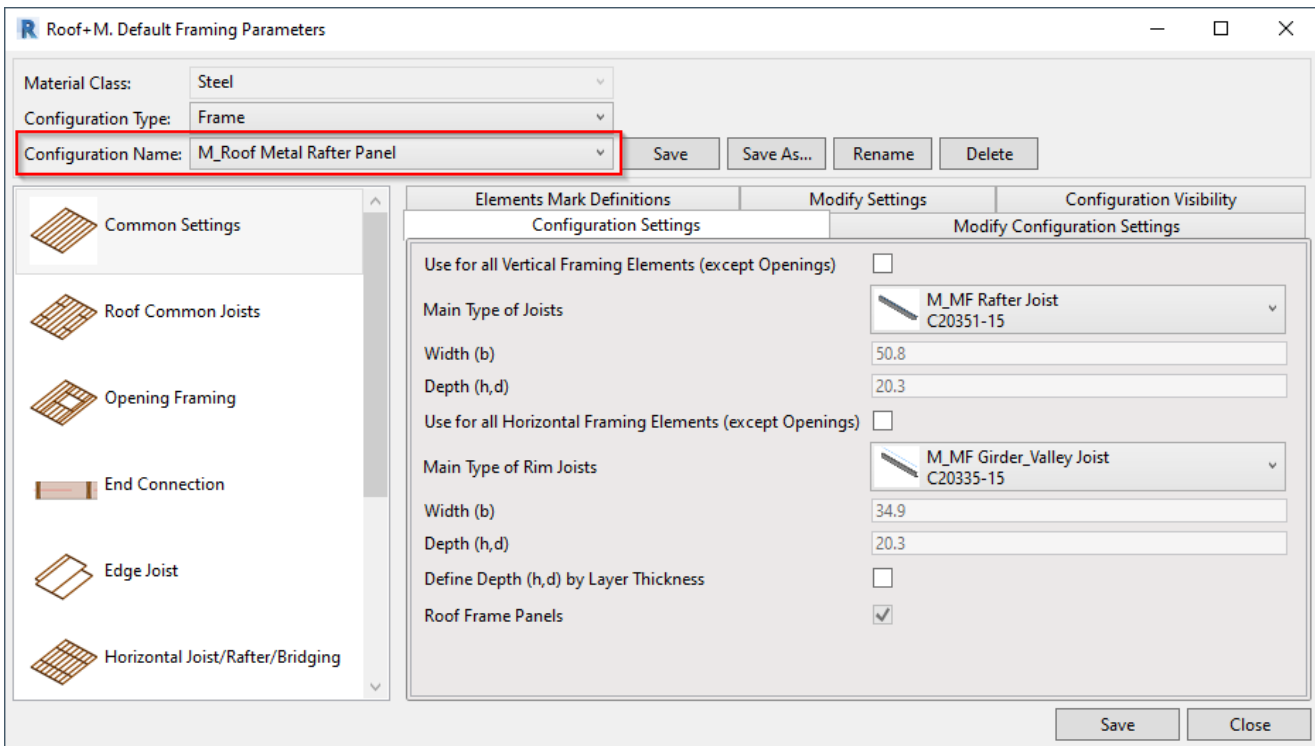

## Fixed or Variable Configuration

Family: Basic Roof  
 Type: Roof 13+203+102+50  
 Total thickness: 369

Layers

EXTERIOR SIDE								
	Function	Material	Thickness	Framing Layer	Framing Configuration	Configuration	Frame	Frame Part
0	Finish2	Roofing	50 mm	Roofing	M_Roof Roofing	Fixed	<input checked="" type="checkbox"/>	<input type="checkbox"/>
1	Substrate	Metal Batten	102 mm	Batten	M_Roof Batten	Fixed	<input checked="" type="checkbox"/>	<input type="checkbox"/>
2	Structure	Metal - Light Gauge Steel	203 mm	Frame	M_Roof Metal Panel	Fixed	<input checked="" type="checkbox"/>	<input type="checkbox"/>
3	Finish1	Wood - Sheathing - plywood	13 mm	Sheathing	-- None --	Fixed	<input type="checkbox"/>	<input type="checkbox"/>

The selected configuration may be FIXED during the framing process or VARIABLE and selected during framing process.

- **Fixed** – after **Frame Roof** command (or when adding additional layers), the software will use the configuration that is set in the **Framing Configuration** column.
- **Variable** – after **Frame Roof** command (or when adding additional layers), the software will ask you which configuration you'd like to use:

*If configuration is variable, then you can select any framing configuration from the list during the framing process:*

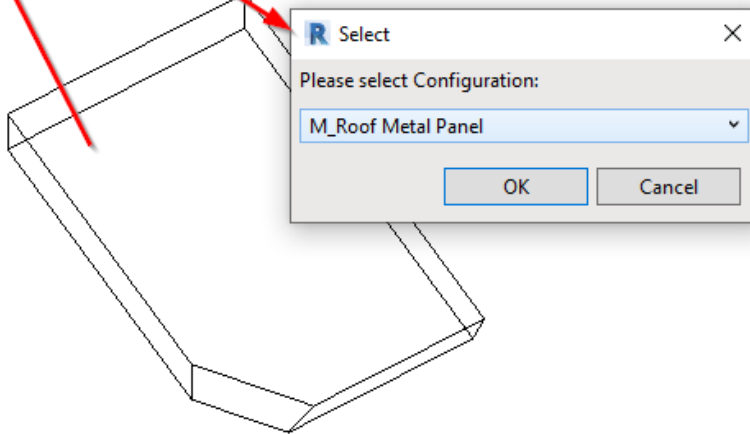
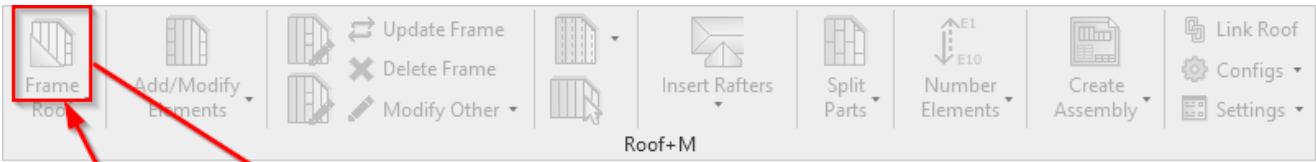

Result:

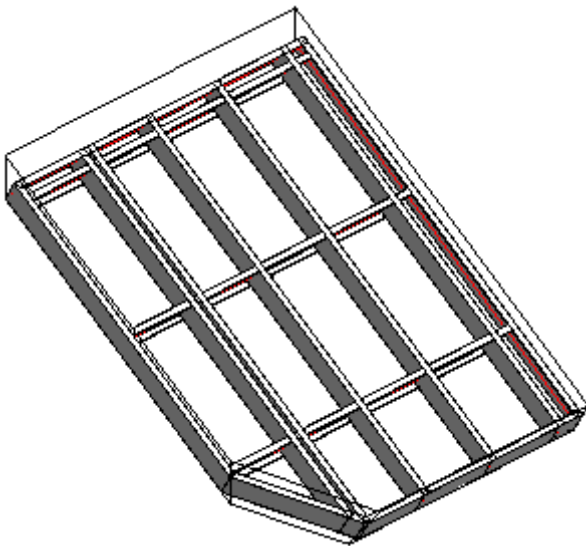

### Frame

Family: Basic Roof  
 Type: Roof 13+203+102+50  
 Total thickness: 369

Layers

EXTERIOR SIDE								
	Function	Material	Thickness	Framing Layer	Framing Configuration	Configuration	Frame	Frame Part
0	Finish2	Roofing	50 mm	Roofing	M_Roof Roofing	Fixed	<input checked="" type="checkbox"/>	<input type="checkbox"/>
1	Substrate	Metal Batten	102 mm	Batten	M_Roof Batten	Fixed	<input checked="" type="checkbox"/>	<input type="checkbox"/>
2	Structure	Metal - Light Gauge Steel	203 mm	Frame	M_Roof Metal Panel	Fixed	<input checked="" type="checkbox"/>	<input type="checkbox"/>
3	Finish1	Wood - Sheathing - plywood	13 mm	Sheathing	-- None --	Fixed	<input type="checkbox"/>	<input type="checkbox"/>

**Frame** – choose whether layers should be framed during the framing process or later. This is very useful if there are many layers in the roof. For example, there might be two batten layers, but perhaps you only want to frame one of them.

## Frame Part

Family: Basic Roof  
 Type: Roof 13+203+102+50  
 Total thickness: 369  
 Layers

EXTERIOR SIDE								
Framing Layer	Framing Configuration	Configuration	Frame	Frame Part	Split Parts	Split by	Sheathing/Paneling Configuration	Exclude Parts
Roofing	M_Roof Roofing	Fixed	<input checked="" type="checkbox"/>	<input checked="" type="checkbox"/>	<input type="checkbox"/>	<input type="checkbox"/>	-- None --	<input checked="" type="checkbox"/>
Batten	M_Roof Batten	Fixed	<input checked="" type="checkbox"/>	<input checked="" type="checkbox"/>	<input type="checkbox"/>	<input type="checkbox"/>	-- None --	<input checked="" type="checkbox"/>
Frame	M_Roof Metal Panel	Fixed	<input checked="" type="checkbox"/>	<input checked="" type="checkbox"/>	<input type="checkbox"/>	<input type="checkbox"/>	-- None --	<input checked="" type="checkbox"/>
Sheathing	-- None --	Fixed	<input type="checkbox"/>	<input type="checkbox"/>	<input checked="" type="checkbox"/>	<input type="checkbox"/>	Roof Frame - 1 Top & 1 Bottom l	<input type="checkbox"/>

**Frame Part** – frames separate parts, not the whole roof layer.

When framing a prefabricated roof panel in Revit, the **Frame Part** function is useful when you have parts of the roof that do not belong to the prefabricated panel, e.g., roofing that will be built in place. Here's a workflow showing how you can frame the parts.

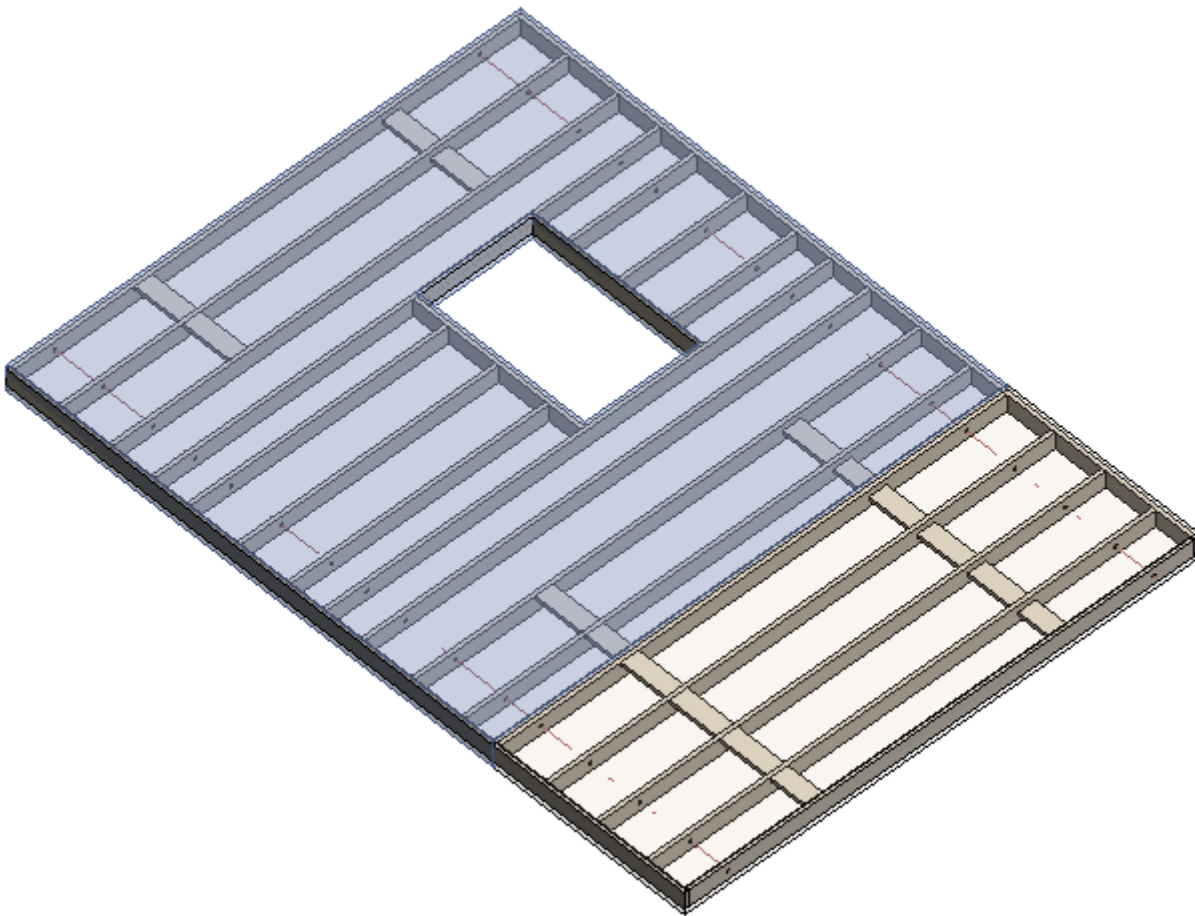

In the above picture, there are two roof panels framed and the roofing needs to be continuous.

1. Turn on **Parts Visibility** in Revit's **View Properties**. Then select and merge the parts:

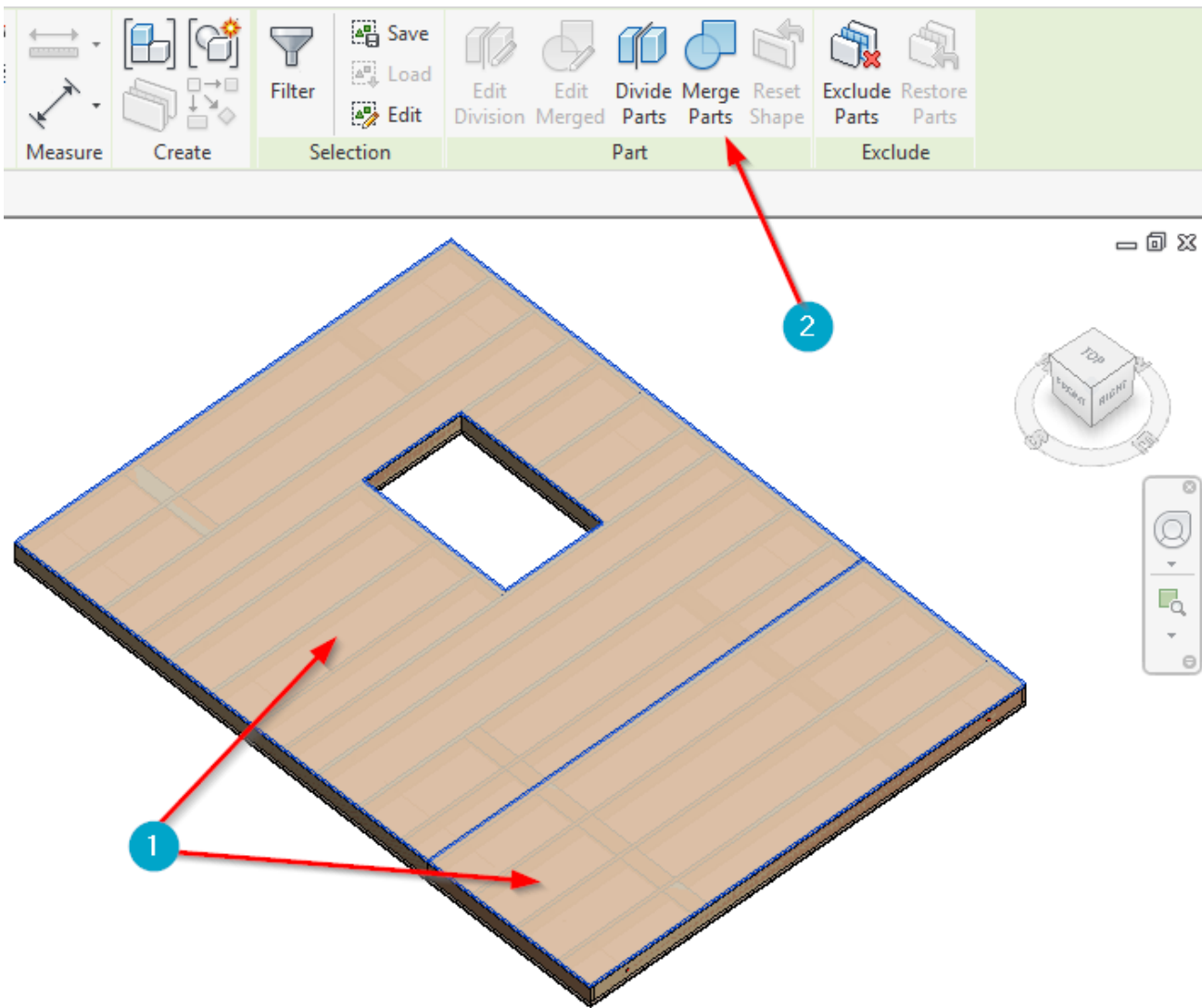

You can also write a framing configuration name for that part in the **Framing Configuration** parameter:

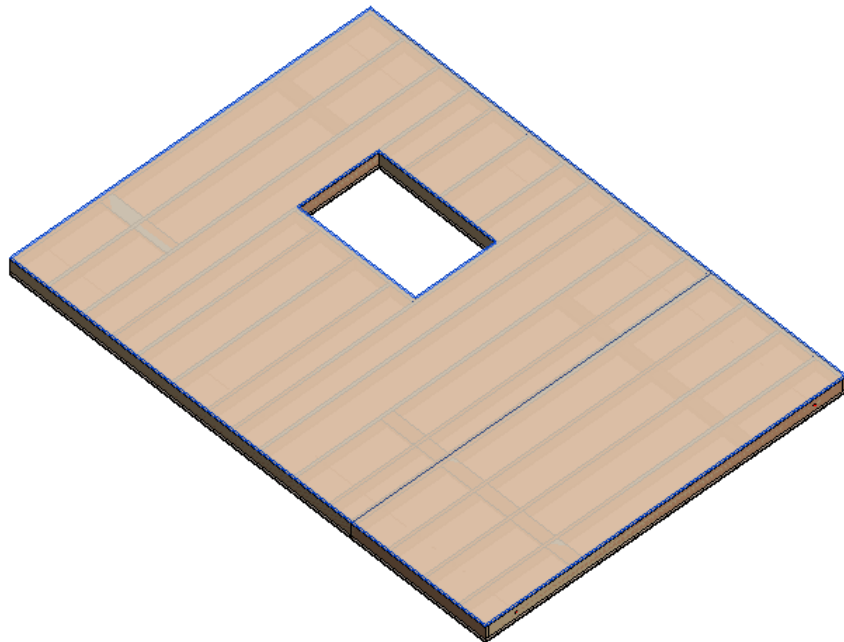
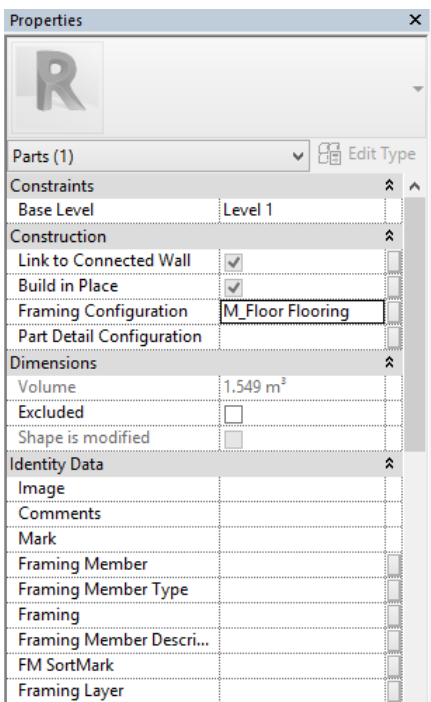

2. In the **Link Roof** dialog, tick **Frame Parts** for that layer:

Family: Basic Roof  
 Type: Roof 13+203+102+50  
 Total thickness: 369

Layers

EXTERIOR SIDE									
Framing Layer	Framing Configuration	Configuration	Frame	Frame Part	Split Parts	Split by	Sheathing/Paneling Configuration	Exclude Parts	
Roofing	M_Roof Roofing	Fixed	<input checked="" type="checkbox"/>	<input checked="" type="checkbox"/>	<input type="checkbox"/>	<input type="checkbox"/>	-- None --	<input checked="" type="checkbox"/>	
Batten	M_Roof Batten	Fixed	<input checked="" type="checkbox"/>	<input type="checkbox"/>	<input type="checkbox"/>	<input type="checkbox"/>	-- None --	<input checked="" type="checkbox"/>	
Frame	M_Roof Metal Panel	Fixed	<input checked="" type="checkbox"/>	<input type="checkbox"/>	<input type="checkbox"/>	<input type="checkbox"/>	-- None --	<input checked="" type="checkbox"/>	
Sheathing	-- None --	Fixed	<input type="checkbox"/>	<input type="checkbox"/>	<input checked="" type="checkbox"/>	<input type="checkbox"/>	Roof Frame - 1 Top & 1 Bottom I	<input type="checkbox"/>	

3. Going back to the original view, select the part and use **Add Roofing**.

As a result, you'll have split roof panels (with the main frame, battens, and so on) and a separate roofing layer that is not split or can be split differently:

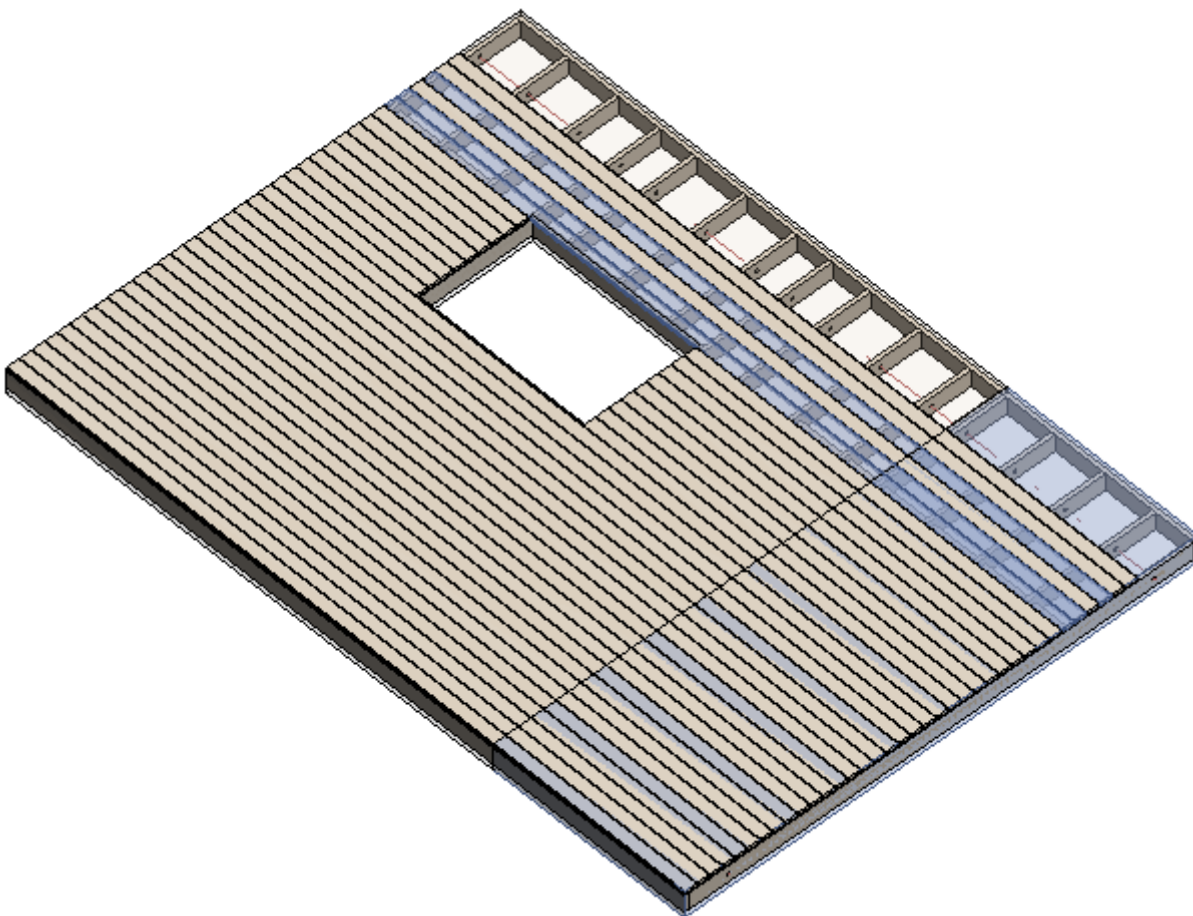

## Split Parts



Family: Basic Roof  
 Type: Roof 13+203+102+50  
 Total thickness: 369

## Layers

EXTERIOR SIDE								
Framing Layer	Framing Configuration	Configuration	Frame	Frame Part	Split Parts	Split by	Sheathing/Paneling Configuration	Exclude Parts
Roofing	M_Roof Roofing	Fixed	<input checked="" type="checkbox"/>	<input checked="" type="checkbox"/>	<input type="checkbox"/>	<input type="checkbox"/>	-- None --	<input checked="" type="checkbox"/>
Batten	M_Roof Batten	Fixed	<input checked="" type="checkbox"/>	<input checked="" type="checkbox"/>	<input type="checkbox"/>	<input type="checkbox"/>	-- None --	<input checked="" type="checkbox"/>
Frame	M_Roof Metal Panel	Fixed	<input checked="" type="checkbox"/>	<input checked="" type="checkbox"/>	<input type="checkbox"/>	<input type="checkbox"/>	-- None --	<input checked="" type="checkbox"/>
Sheathing	-- None --	Fixed	<input type="checkbox"/>	<input type="checkbox"/>	<input checked="" type="checkbox"/>	<input type="checkbox"/>	Roof Frame - 1 Top & 1 Bottom l	<input type="checkbox"/>

**Split Parts** – select if parts need to be split after using **Split Parts** function or should be split later. This is very useful if there are many layers in the roof, for example, two sheathing/paneling layers and you only want to split one.

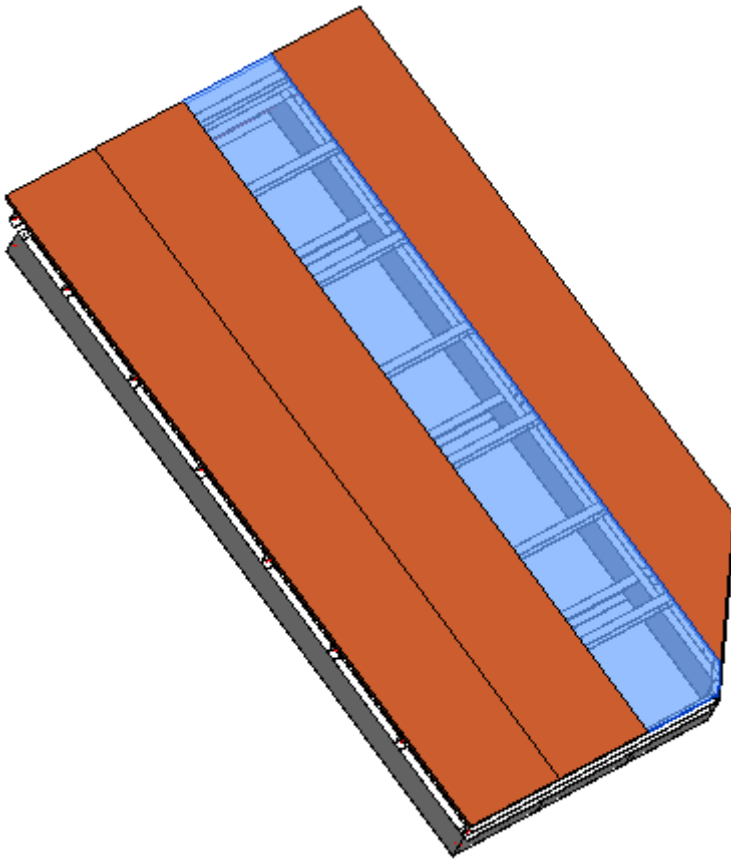
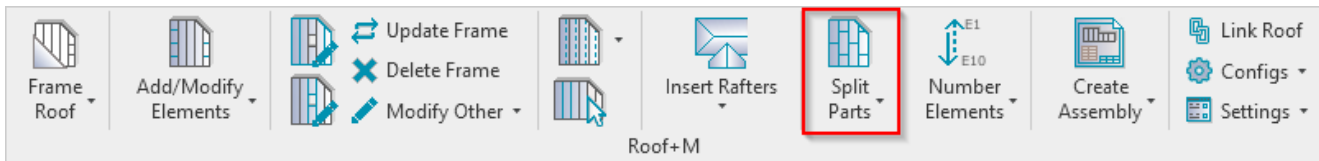

## Split by

Family: Basic Roof  
 Type: Roof 13+203+ 102+50  
 Total thickness: 369

Layers

EXTERIOR SIDE								
Framing Layer	Framing Configuration	Configuration	Frame	Frame Part	Split Parts	Split by	Sheathing/Paneling Configuration	Exclude Parts
Roofing	M_Roof Roofing	Fixed	<input checked="" type="checkbox"/>	<input type="checkbox"/>	<input type="checkbox"/>	<input type="checkbox"/>	-- None --	<input checked="" type="checkbox"/>
Batten	M_Roof Batten	Fixed	<input checked="" type="checkbox"/>	<input type="checkbox"/>	<input type="checkbox"/>	<input type="checkbox"/>	-- None --	<input checked="" type="checkbox"/>
Frame	M_Roof Metal Panel	Fixed	<input checked="" type="checkbox"/>	<input type="checkbox"/>	<input type="checkbox"/>	<input checked="" type="checkbox"/>	-- None --	<input checked="" type="checkbox"/>
Sheathing	-- None --	Fixed	<input type="checkbox"/>	<input type="checkbox"/>	<input checked="" type="checkbox"/>	<input type="checkbox"/>	Roof Frame - 1 Top & 1 Bottom I	<input type="checkbox"/>

**Split by** – select framing layer to be used for splitting sheathing/paneling.

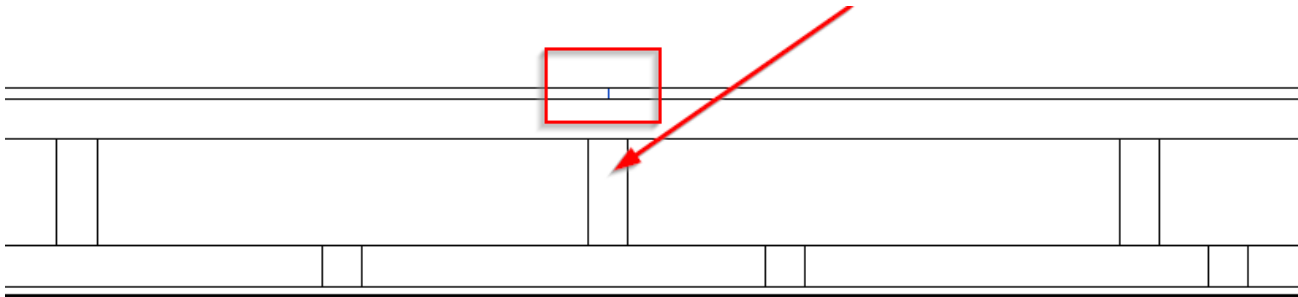

### Sheathing/Paneling Configuration

Family: Basic Roof  
 Type: Roof 13+203+ 102+50  
 Total thickness: 369

Layers

EXTERIOR SIDE								
Framing Layer	Framing Configuration	Configuration	Frame	Frame Part	Split Parts	Split by	Sheathing/Paneling Configuration	Exclude Parts
Roofing	M_Roof Roofing	Fixed	<input checked="" type="checkbox"/>	<input type="checkbox"/>	<input type="checkbox"/>	<input type="checkbox"/>	-- None --	<input checked="" type="checkbox"/>
Batten	M_Roof Batten	Fixed	<input checked="" type="checkbox"/>	<input type="checkbox"/>	<input type="checkbox"/>	<input type="checkbox"/>	-- None --	<input checked="" type="checkbox"/>
Frame	M_Roof Metal Panel	Fixed	<input checked="" type="checkbox"/>	<input type="checkbox"/>	<input type="checkbox"/>	<input checked="" type="checkbox"/>	-- None --	<input checked="" type="checkbox"/>
Sheathing	-- None --	Fixed	<input type="checkbox"/>	<input type="checkbox"/>	<input checked="" type="checkbox"/>	<input type="checkbox"/>	Roof Frame - 1 Top & 1 Bottom I	<input type="checkbox"/>

**Sheathing/Paneling Configuration** – select sheathing/paneling configuration with definition of all sheathing/paneling parameters. There are default configurations that come with **Roof+M**, but you can also create your own.

The list of sheathing/paneling configurations comes from here:

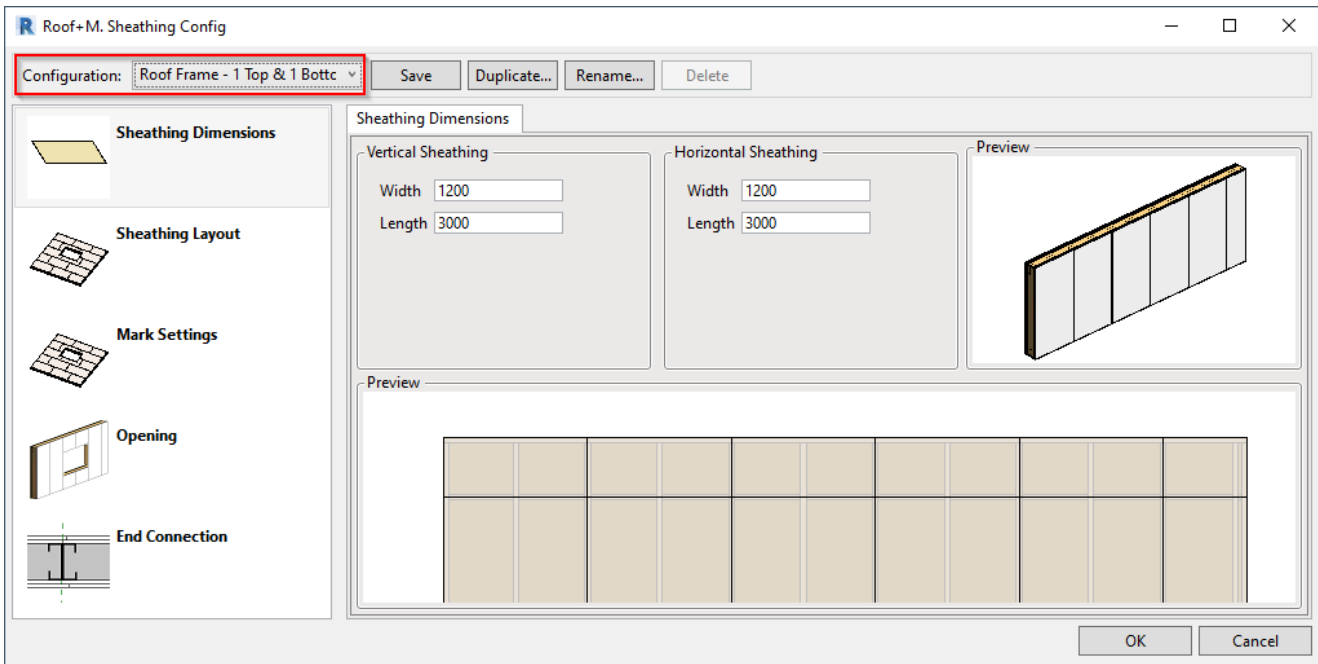
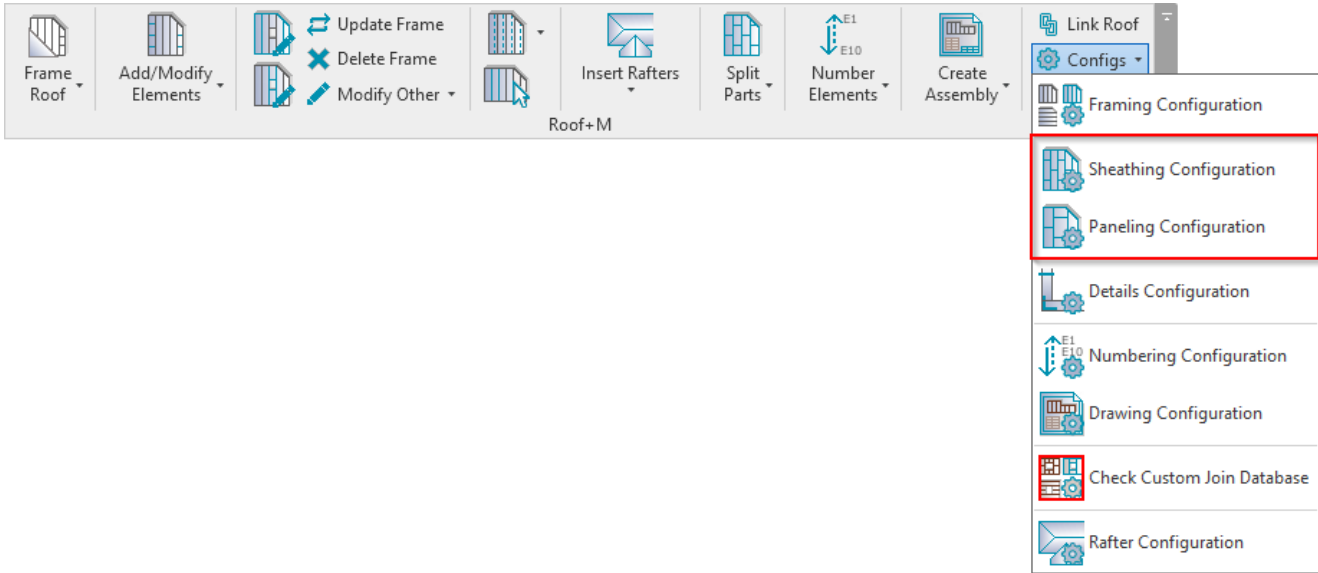

### Exclude Parts

Family: Basic Roof  
 Type: Roof 13+203+102+50  
 Total thickness: 369

Layers

EXTERIOR SIDE								
Framing Layer	Framing Configuration	Configuration	Frame	Frame Part	Split Parts	Split by	Sheathing/Paneling Configuration	Exclude Parts
Roofing	M_Roof Roofing	Fixed	<input checked="" type="checkbox"/>	<input type="checkbox"/>	<input type="checkbox"/>	<input type="checkbox"/>	-- None --	<input checked="" type="checkbox"/>
Batten	M_Roof Batten	Fixed	<input checked="" type="checkbox"/>	<input type="checkbox"/>	<input type="checkbox"/>	<input type="checkbox"/>	-- None --	<input checked="" type="checkbox"/>
Frame	M_Roof Metal Panel	Fixed	<input checked="" type="checkbox"/>	<input type="checkbox"/>	<input type="checkbox"/>	<input checked="" type="checkbox"/>	-- None --	<input checked="" type="checkbox"/>
Sheathing	-- None --	Fixed	<input type="checkbox"/>	<input type="checkbox"/>	<input checked="" type="checkbox"/>	<input type="checkbox"/>	Roof Frame - 1 Top & 1 Bottom l	<input type="checkbox"/>

**Exclude Parts** – select the parts that need to be excluded from the roof. You can exclude parts from the project so that they will not be included in material takeoffs, schedules, and other lists or calculations.

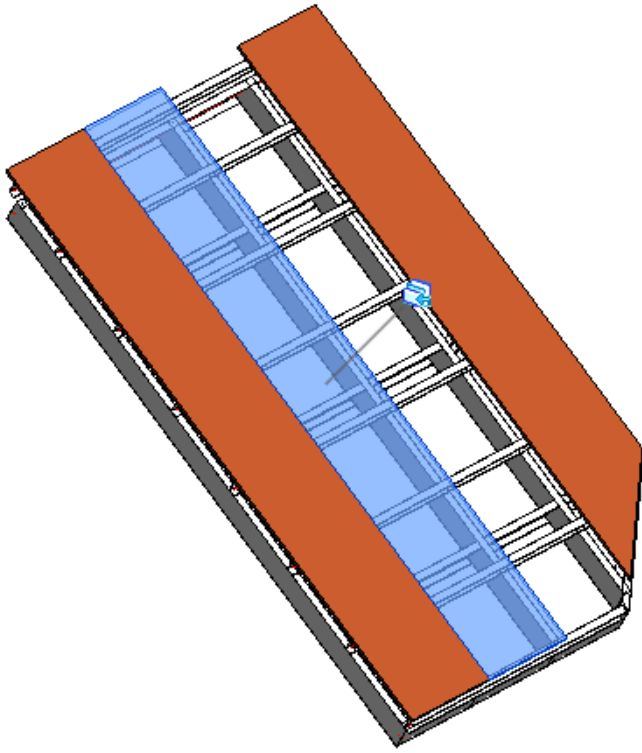

Properties

**R**

Parts (1) Edit Type

**Constraints**

Base Level	Roof
------------	------

**Construction**

Link to Connected Wall	<input checked="" type="checkbox"/>
Framing Configuration	
Build in Place	<input checked="" type="checkbox"/>
Part Detail Configuration	

**Dimensions**

Volume	0.0626 m <sup>3</sup>
Area	2.505 m <sup>2</sup>
Thickness	25.0
Excluded	<input checked="" type="checkbox"/>
Shape is modified	<input type="checkbox"/>

[Properties help](#) Apply