

ALIGN/TRIM/EXTEND – Split Elements

Modified on: Sat, 16 Jan, 2021 at 8:43 PM

Split Elements

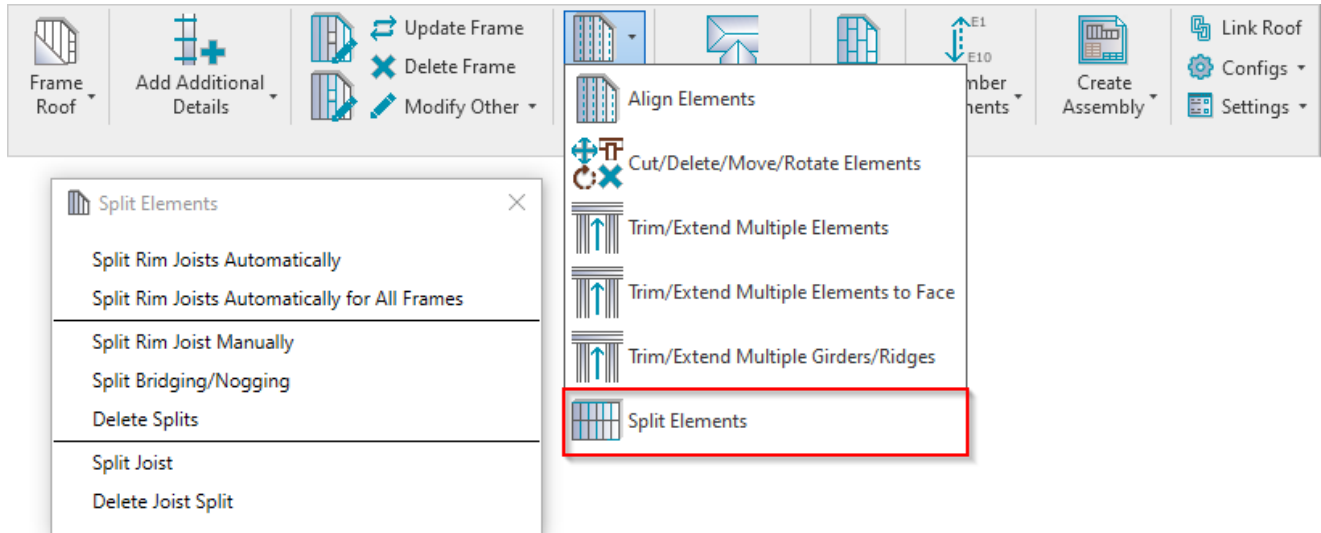

Split Elements – features for splitting joists, rim joists, bridging/nogging elements by different rules.

Split Rim Joists Automatically

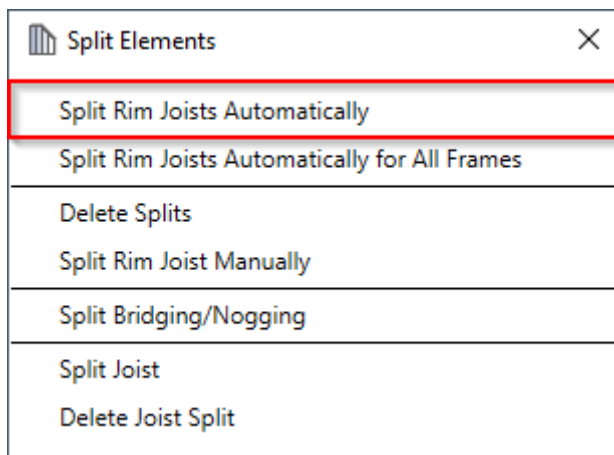

Split Rim Joists Automatically – splits rim joists for selected roof according to predefined settings in **Framing Configuration**.

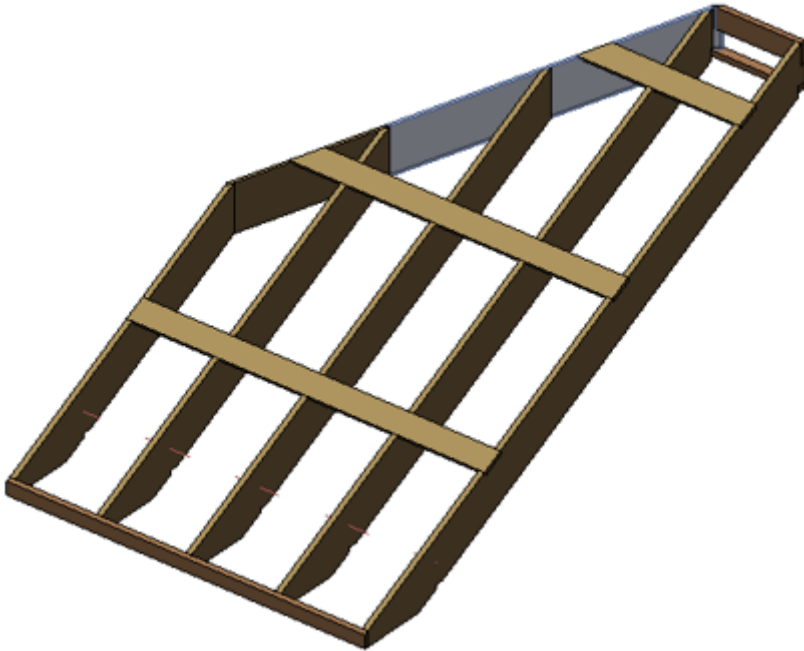

Split settings come from **Configs** → **Framing Configuration** → **Common Settings** → **Modify Configuration Settings** tab:

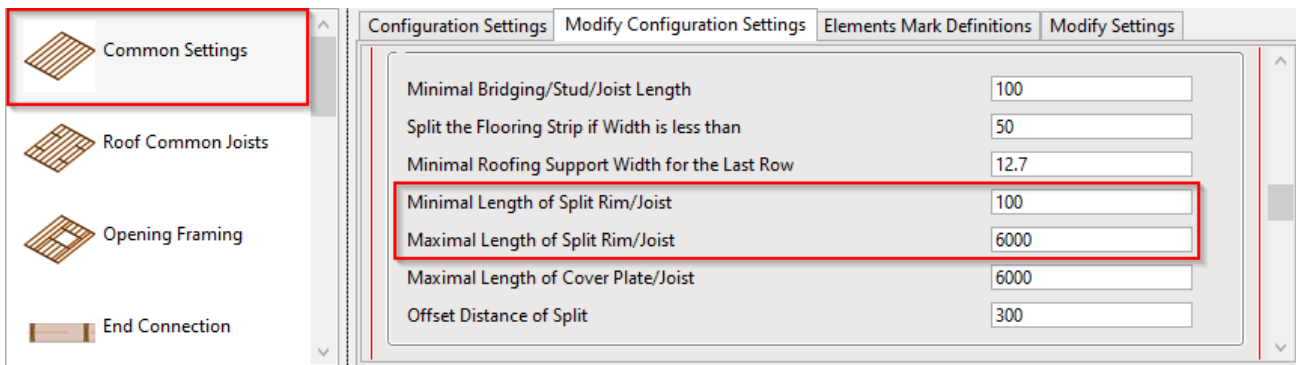

Minimal/Maximal Length of Split Rim/Joist – predefines min/max length for splitting rim joists.

Also, pay attention to **Offset Distance of Split** parameter in **Configs** → **Framing Configuration** → **Common Settings** → **Modify Configuration Settings** tab:

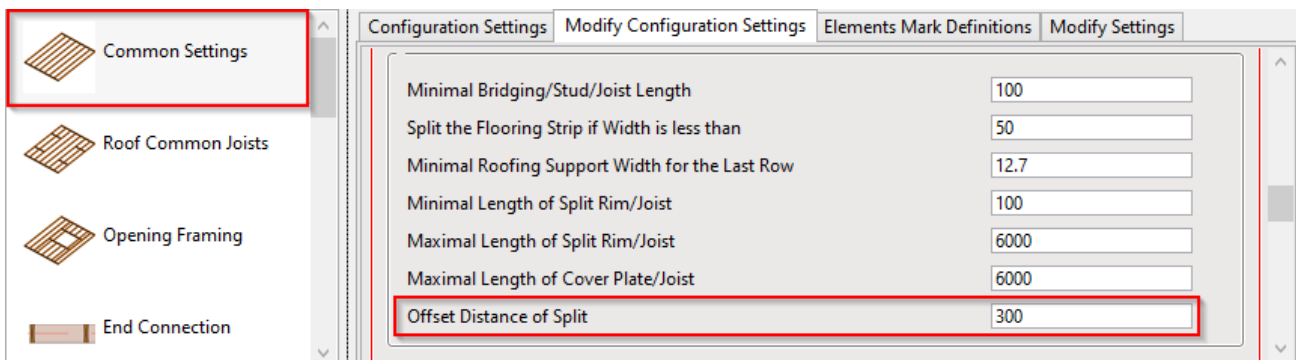

Offset Distance of Split – defines splitting distance for selected rim joist from selected joist.

Example: Offset Distance of Split = 300mm:

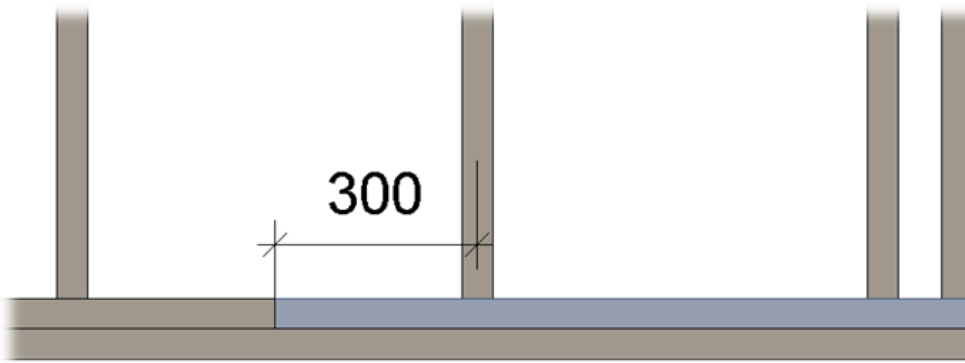

Split Rim Joists Automatically for All Frames

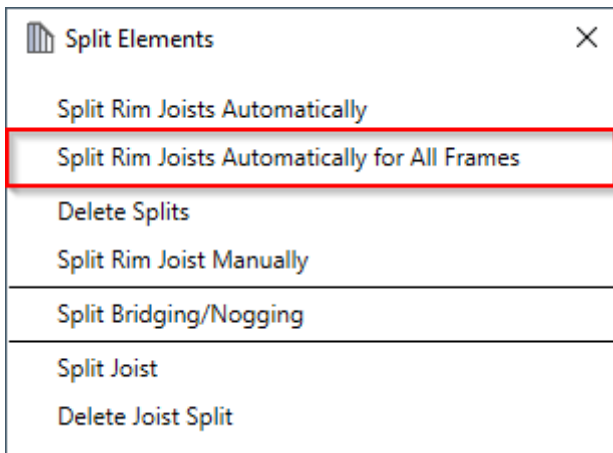

Split Rim Joists Automatically for All Frames – splits rim joists for all roofs in the current project according to predefined settings in **Framing Configuration**.

Delete Splits

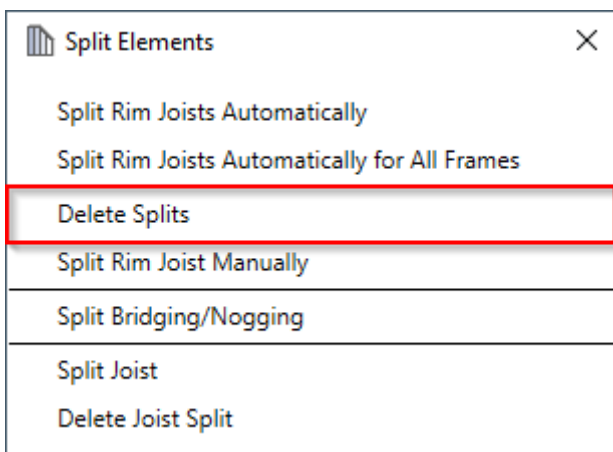

Delete Splits – resets selected roof rim joists to original length before splitting.

Example: rim joists were split...

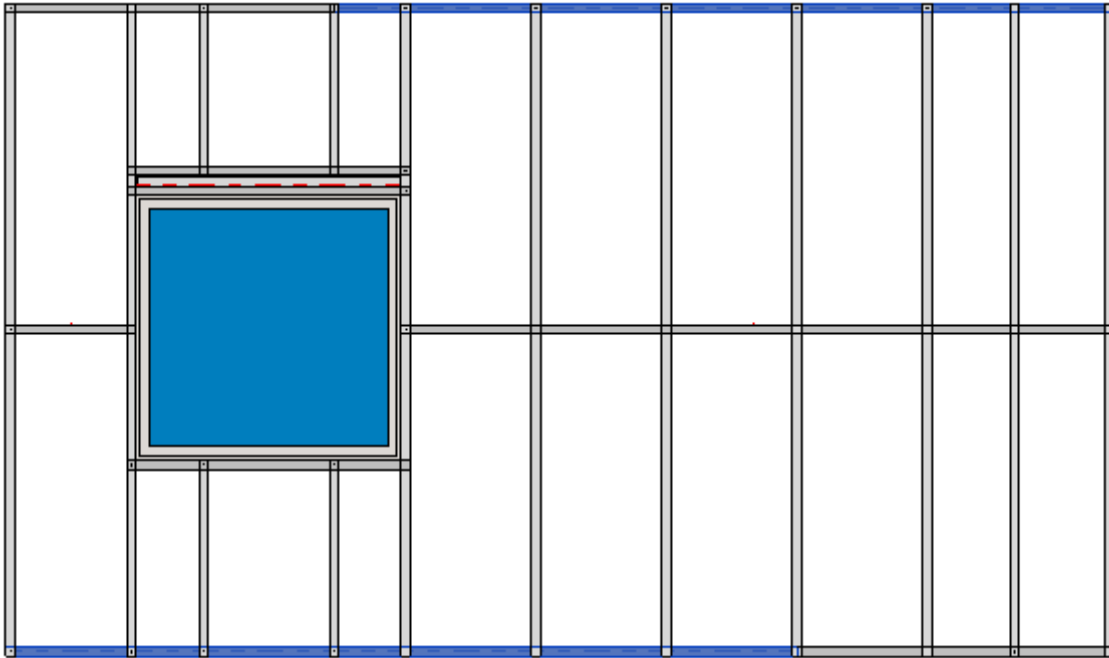

*...after using **Delete Splits**, the rim joists are whole again:*

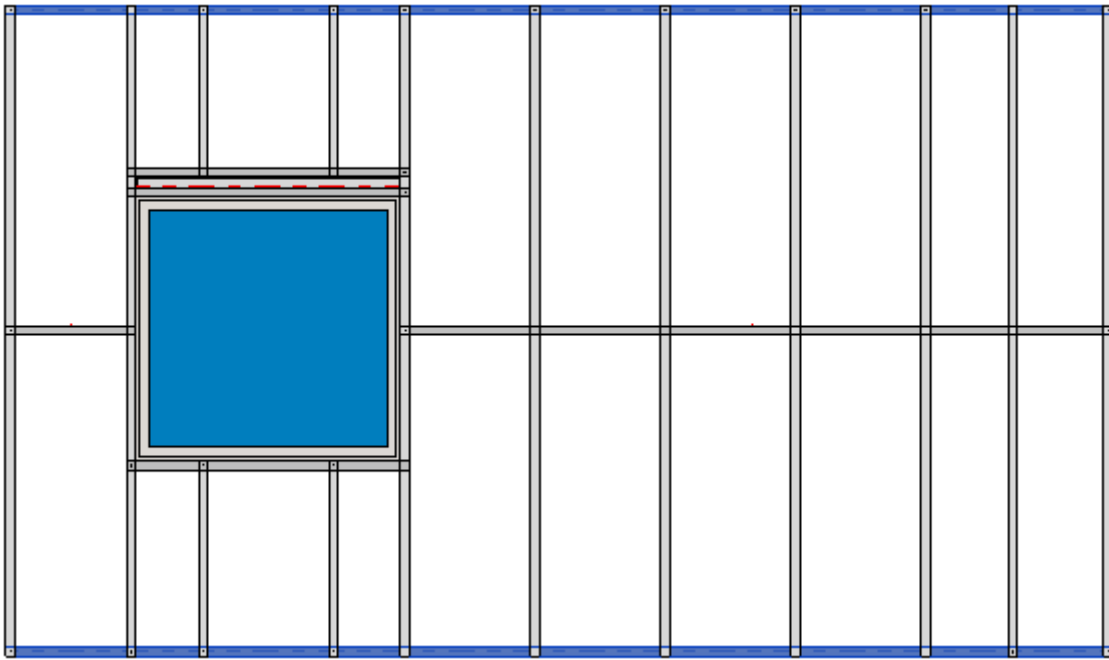

Split Rim Joist Manually

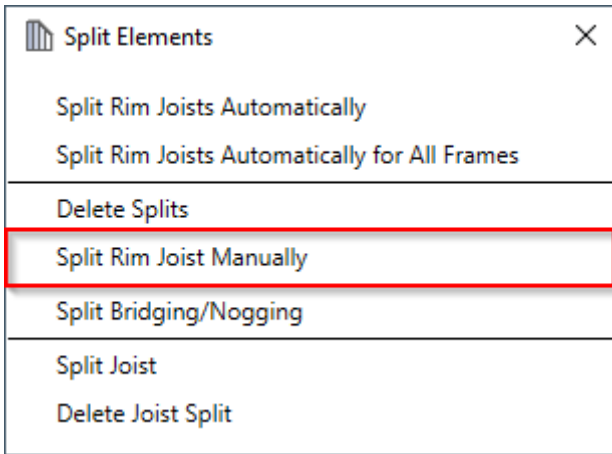

Split Rim Joist Manually – splits selected rim joist by selected joist.

1. Select a joist which will split top/bottom plate;
2. Select a top or bottom plate which will be split.

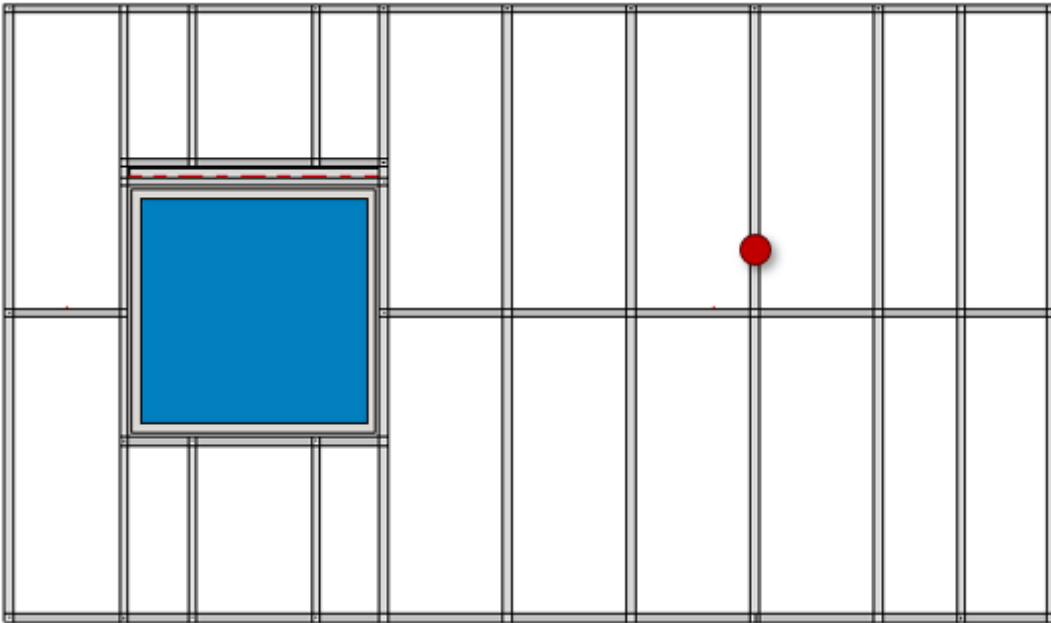

Result:

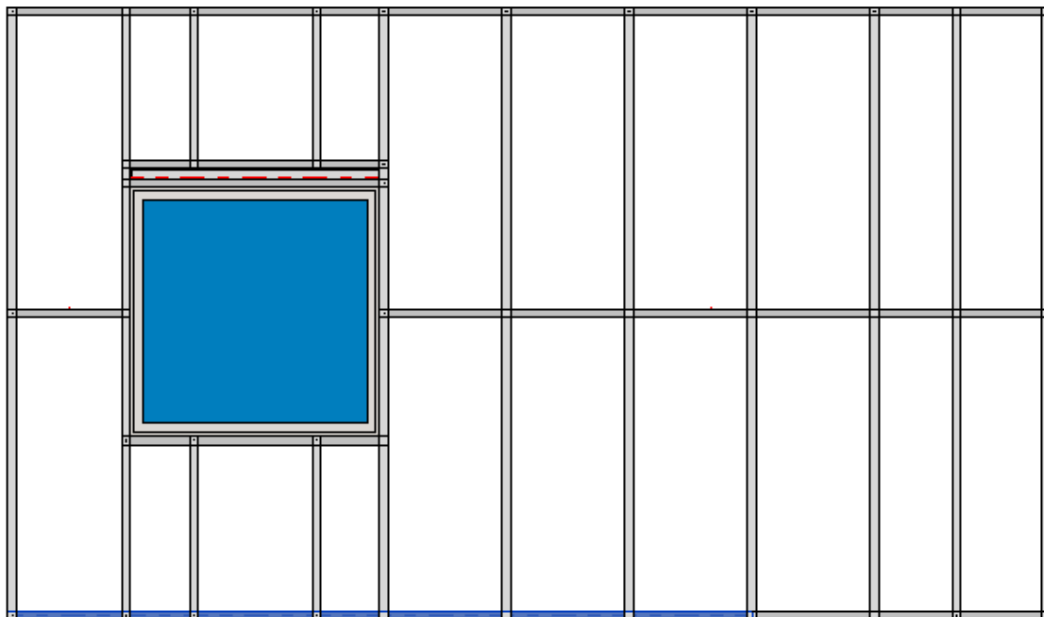

Also, pay attention to **Offset Distance of Split** parameter in **Configs** → **Framing Configuration** → **Common Settings** → **Modify Configuration Settings** tab:

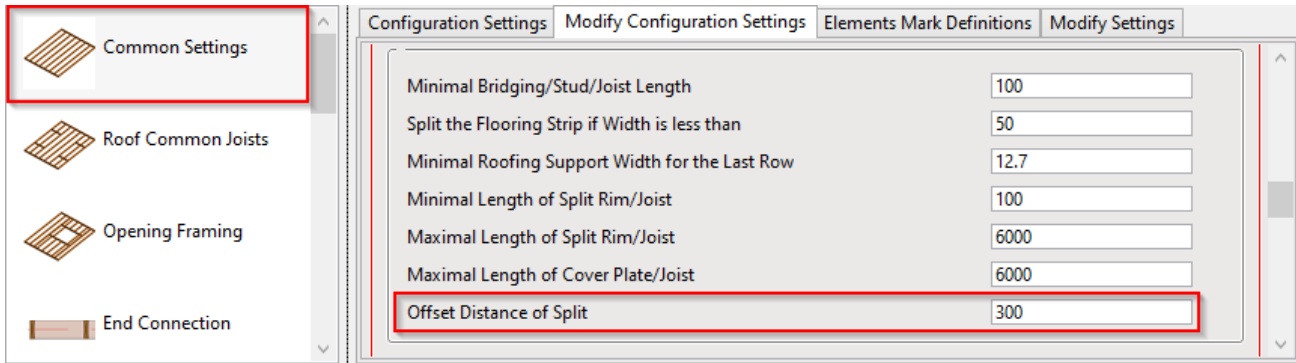

Offset Distance of Split – defines splitting distance for selected rim joist from selected joist.

Example: Offset Distance of Split = 300mm:

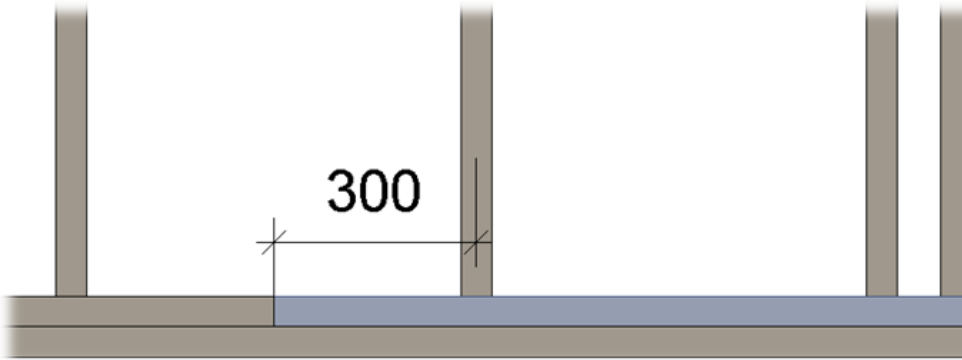

Split Bridging/Nogging

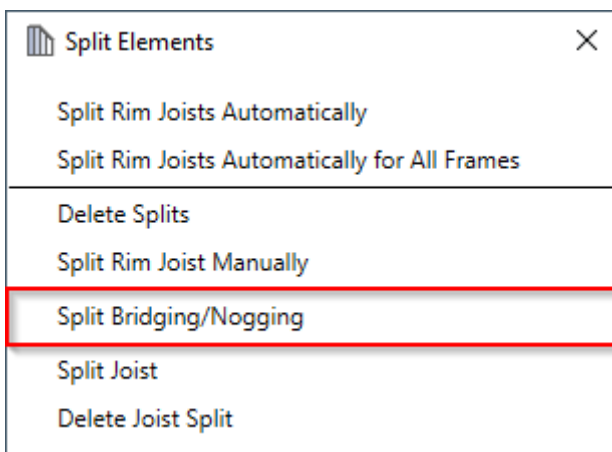

Split Bridging/Nogging – splits selected bridging/nogging by selected joist.

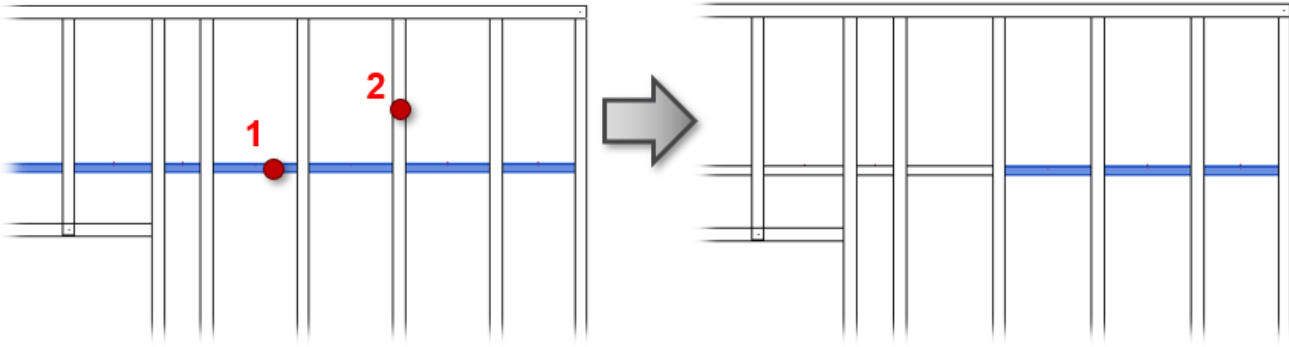

Split Joist

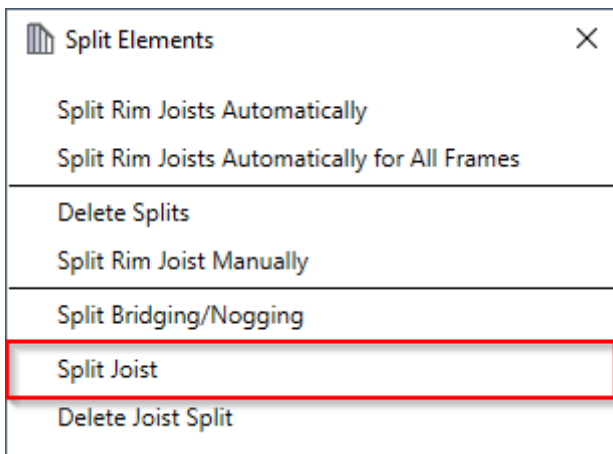

Split Joist – splits selected joists by predefined settings.

You can select one joist or multiple.

For joist splitting you will see a dialog with settings where you can predefine the offset, spacing, number of splits, minimal length of last element, etc.

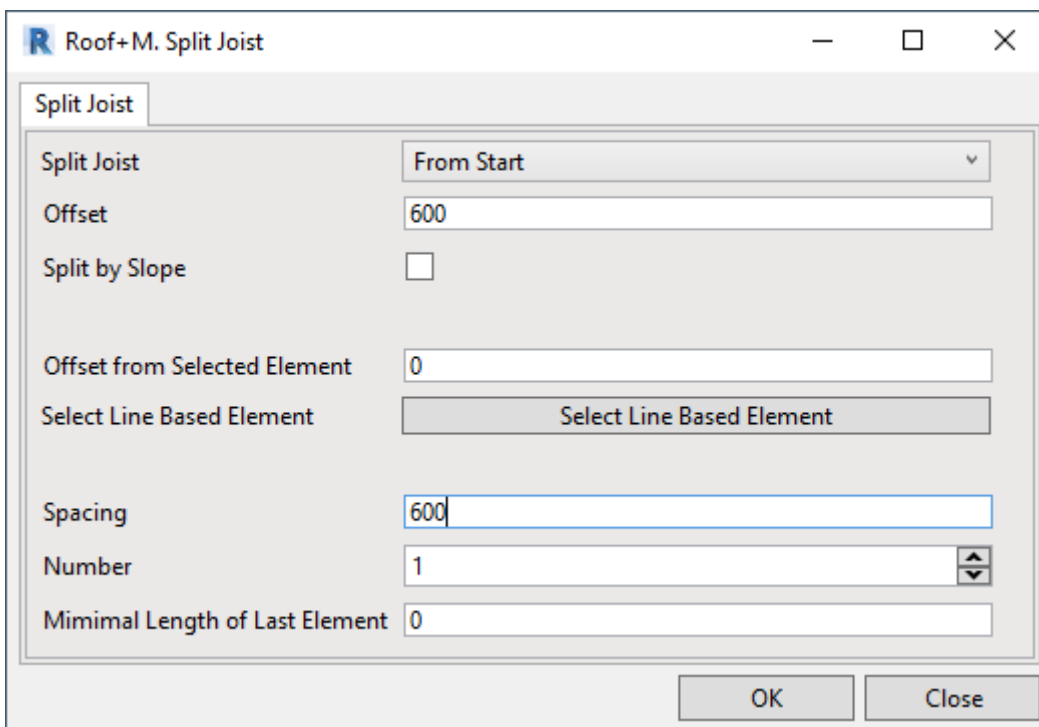

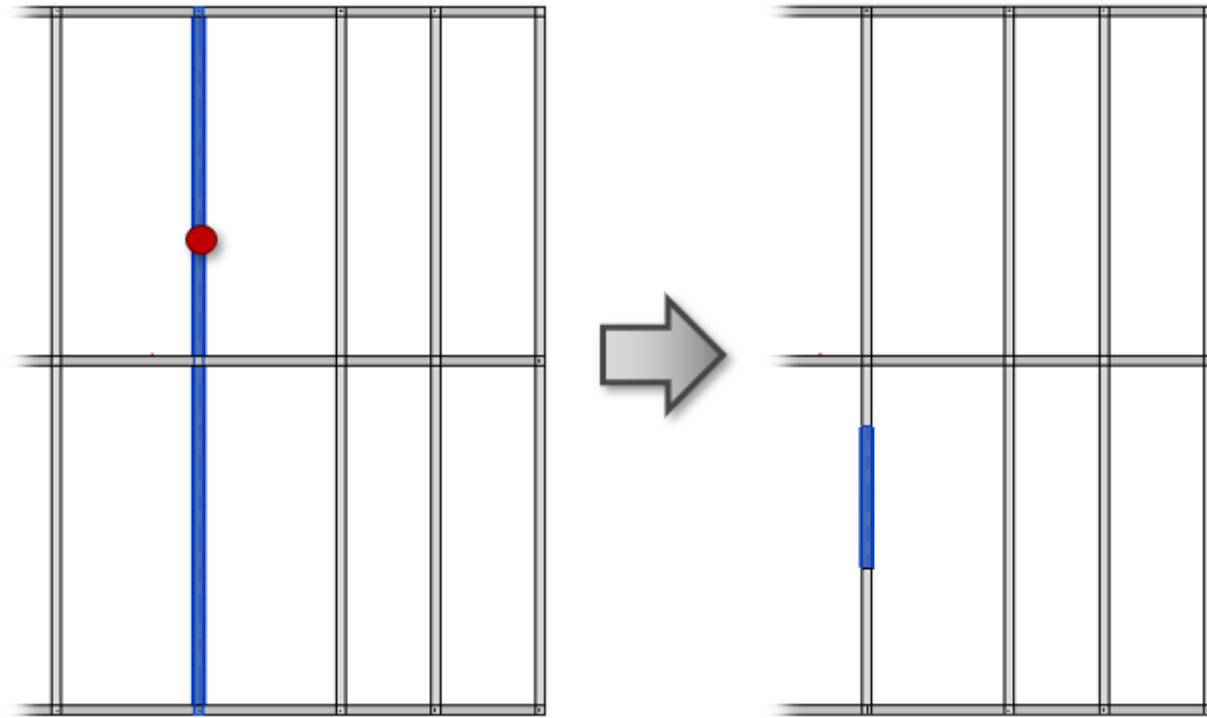

Delete Joist Split

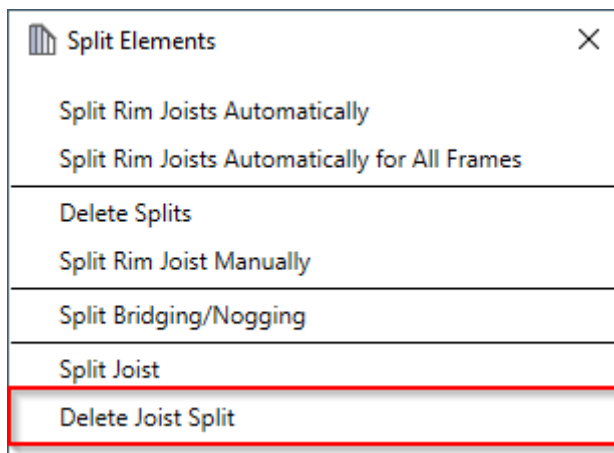

Delete Joist Split – resets selected joists to original length before splitting.

*Select the joist that was split, after clicking **Delete Joist Split**, the joists are restored to original length:*

